

WAHPETON FIRE DEPARTMENT

**PUMPER**

TID NO. 14083



### BODY

- Bolted Painted Stainless Steel Body
- ROM Painted Roll Up Doors
- Rear Slide-In Ladder and Pike Pole Storage
- Above Compartment Hard Suction Storage
- Storage for 8 SCBA Bottles in Wheel Wells
- Slide-Out Floor Dry Compartment in Wheel Well
- Rear Mounted Ladder for Easy Hosebed Access
- Treadplate Hosebed Cover
- Slide-Out and Swing-Out Tool Boards
- Roll-Out Storage Tray

### CHASSIS

- Spartan Metro Star MFD with 10" Raised Roof
- Cummins ISL9 380 HP Engine
- 3000 EVS Transmission
- Seating for 6 Firefighters
- Back-Up Camera

### TANK

- 750 Gallon UPF Tank
- ICI SL Plus Tank Gauge
- Rear Master Intake

### PUMP

- Waterous CSU 1500 GPM Pump
- FRC In Control 400 Pressure Governor
- Foam Pro 2002 Class A Foam System with 25 Gal. Foam Tank
- Left side: 2.5" Intake Master Intake
- Right side: (2) 2.5" Discharges  
4" Discharge  
2.5" Intake  
Master Intake
- (3) Rear 2.5" Discharges
- TFT XFT Monitor with 18" Extenda Gun
- Front Bumper Hosewell with 2.5" Discharge
- 2.5" Crosslay
- (2) 1.75" Crosslays
- Booster Reel

### ELECTRICAL

- Command Light Tower
- Whelen Warning Lighting
- Whelen LED Arrowstick
- Whelen PFH1 Brow Light
- Kussmaul 2000 Watt Inverter
- Whelen Scene Lights
- ILI LED Strip Compartment Lighting

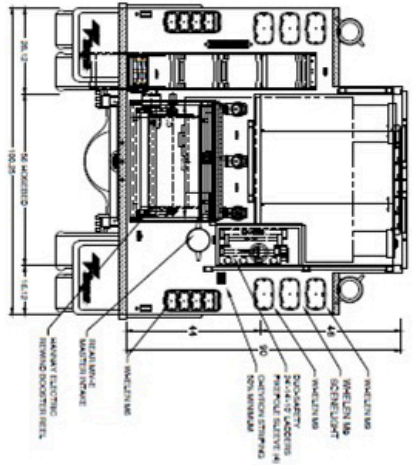

COMP.	HEIGHT	WIDTH	GROUND CLEARANCE	WEIGHT
ENGINE	67.12	47.25	1.5	18.5
TRANSMISSION	57.12	63.75	1.5	15.6
DRIVE SHAFT	67.12	44.50	1.5	11.4
REAR AXLE	57.12	63.75	1.5	18.18
FRONT AXLE	67.12	44.50	1.5	11.4
STEERING	7.12	14.5	1.5	5.52
WHEELS	11.12	14.5	1.5	8.67

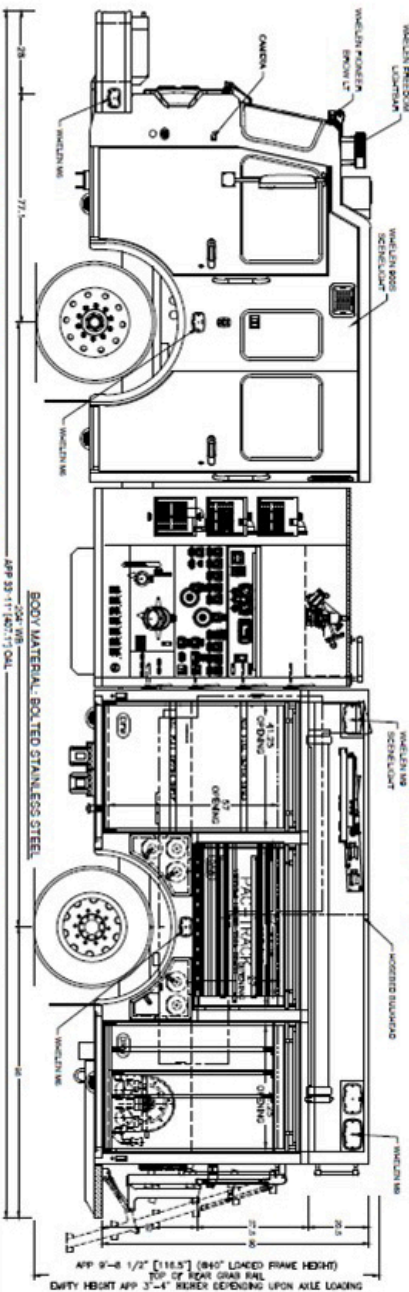
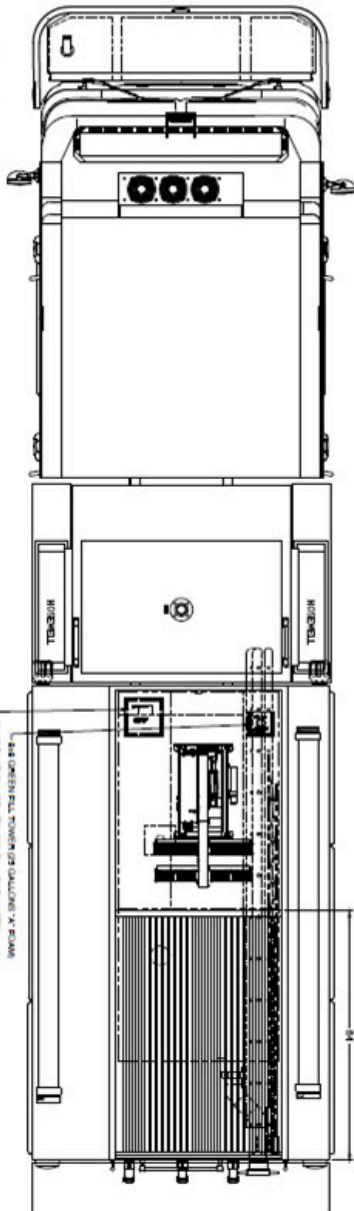
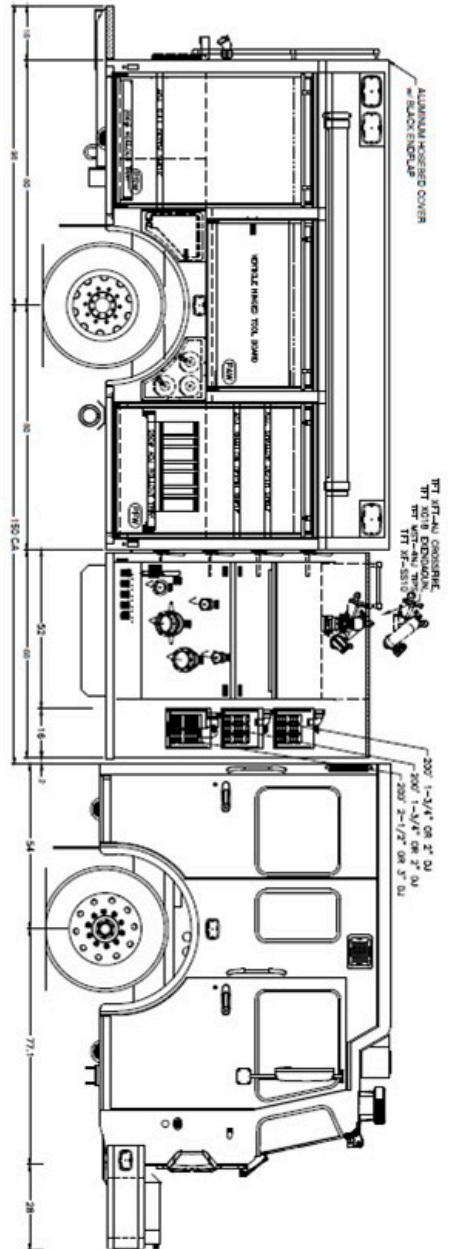
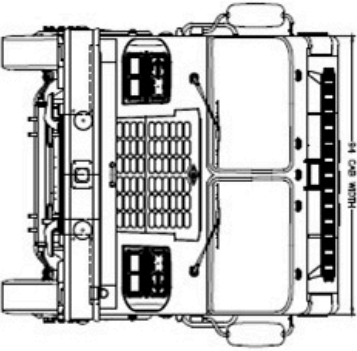

**NOTE:**

DIMENSIONS SHOWN ARE APPROXIMATE AND ARE SUBJECT TO MINOR CHANGE AS MAY BE FOUND NECESSARY DURING CONSTRUCTION. MINOR DETAILS MAY NOT BE SHOWN. IF DISCREPANCIES EXIST BETWEEN THIS DRAWING AND THE WRITTEN SPECIFICATIONS PROVIDED BY TOYNE, THE WRITTEN SPECIFICATIONS SHALL PREVAIL.

ORIGINAL DRAWING	22AUG23	CHASSIS:	SPARTAN METROSTAR MFD 10' RR	SCALE:	1:66	SHEET:	A
REV A	18DEC23	WB-CALF:	204'-150'-47" D17	CITY:	--		
ISR	03JAN24	BODY MATL:	BOLTED STAINLESS STEEL	STATE:	--		
		PUMP:	WATEROUS CSU 1500	DUR:	MAT		
		TANK:	750/25 1" POLY-TANK	CAD:	GROSSMAN		
		FOAM SYSTEM:	FOAM PRO 2002 7"	DATE:	23 AUGUST 2023		
		GENERATOR:	N/A	FILE:	WAHPETON3		

**WAHPETON**  
CUSTOM PUMPER

**Toyne**  
BREA, IA 51436  
800 648 3358  
WWW.TOYNE.COM